

## MEMORIA DE CÁLCULOS:

### ITEM 2.1

### VARREDURA DA SUPERFÍCIE PARA EXECUÇÃO DE REVESTIMENTO ASFÁLTICO: ROTATORIA MARCO VISUAL “CARRO DE BOIS”:

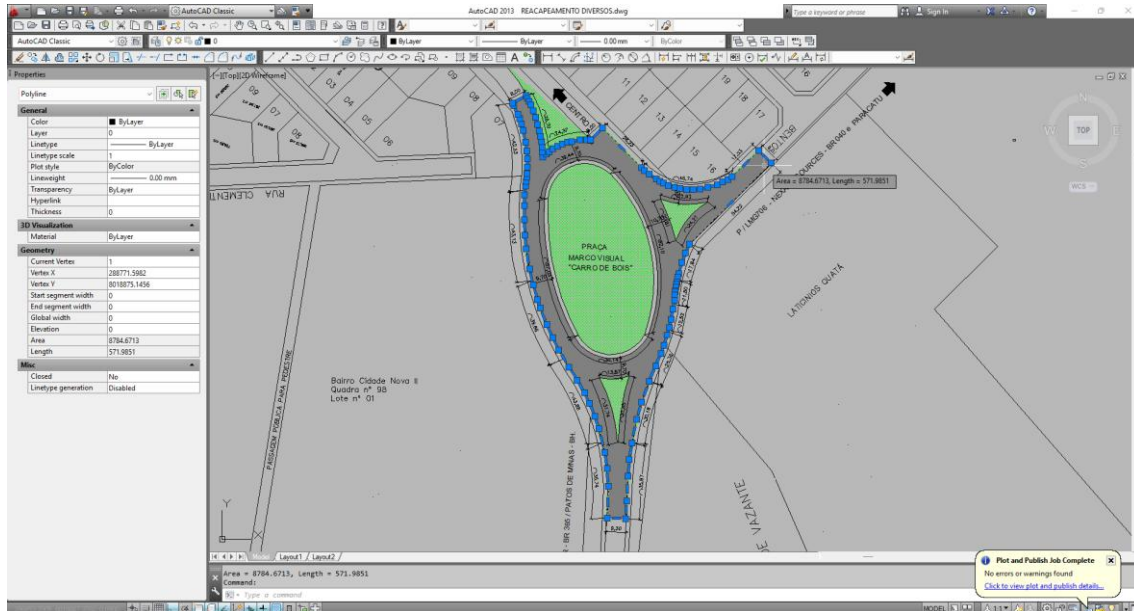

AREA 1 = 8.784,67 m2.

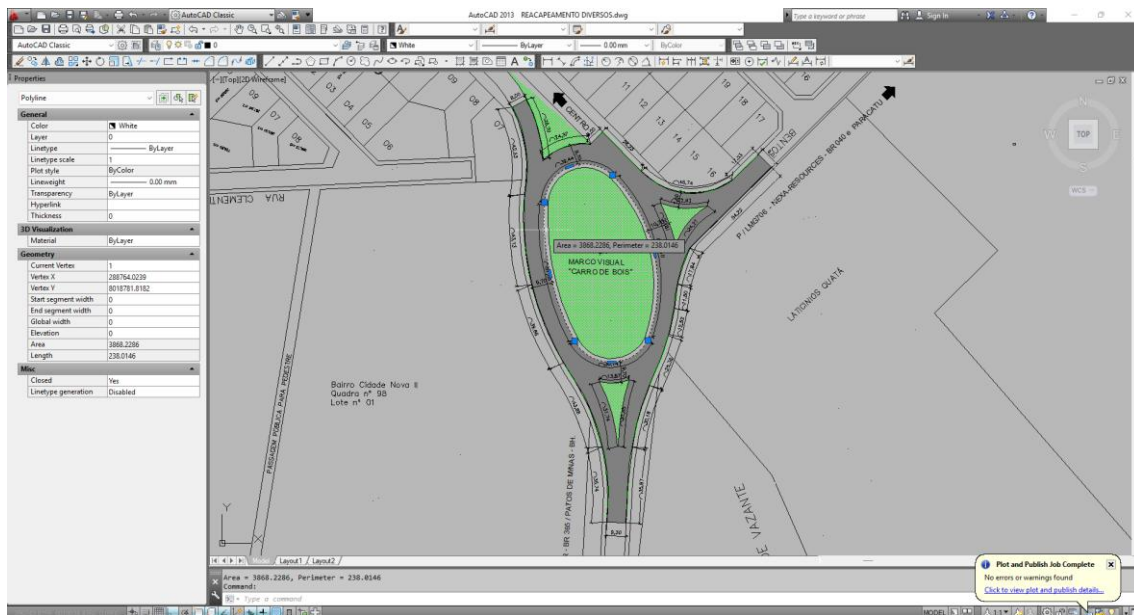

AREA 2 = 3.868,22 m2.

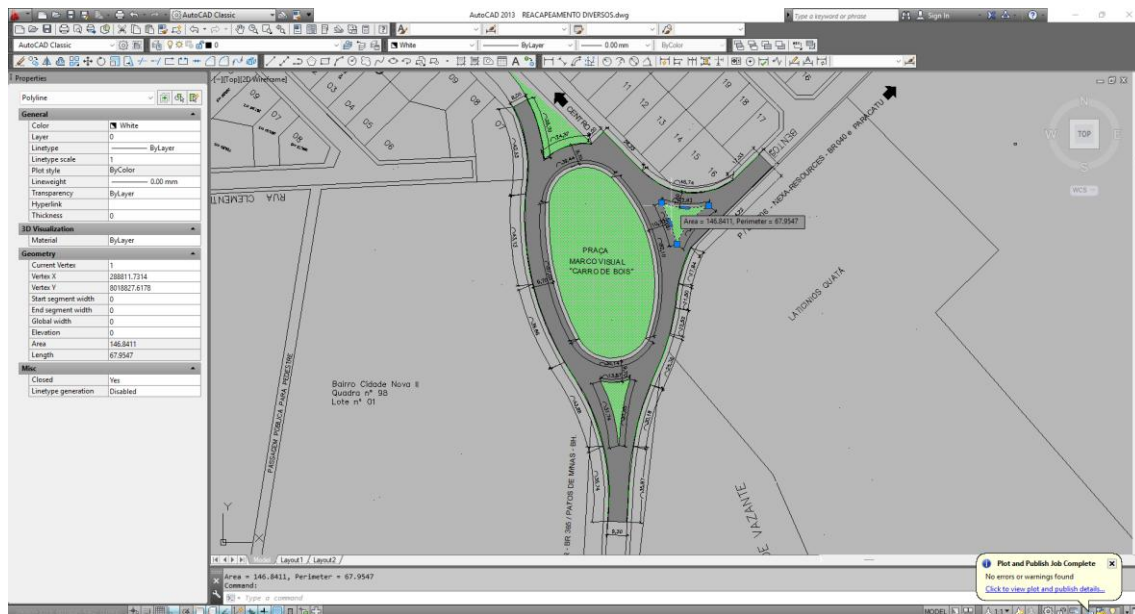

AREA 3 = 146,84 m2.

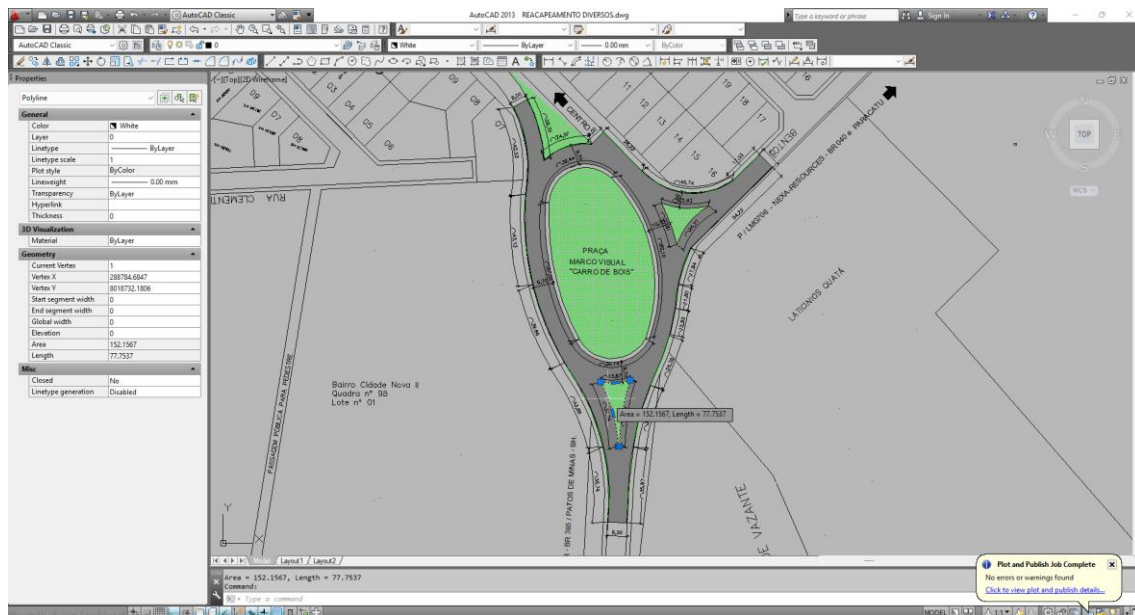

AREA 4 = 152,15 m2.

Total (8.784,67 - 3.868,22 - 146,84 - 152,15) = **4.617,46 m2.**

**RUA GERALDO TOMAZ DE AQUINO:**

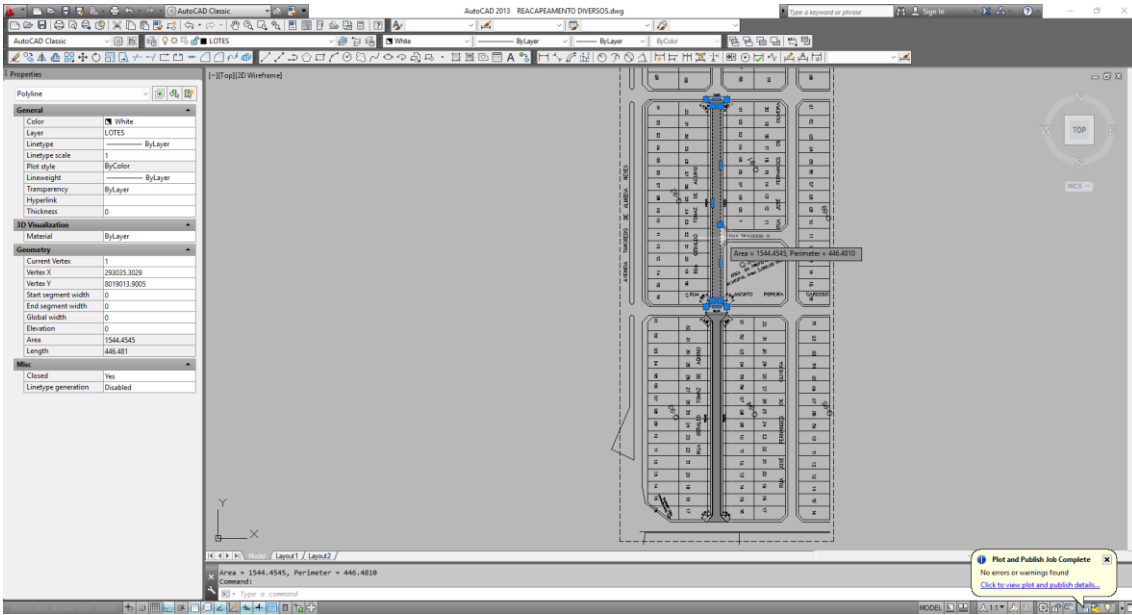

AREA 1 – 1.544,45 m2.

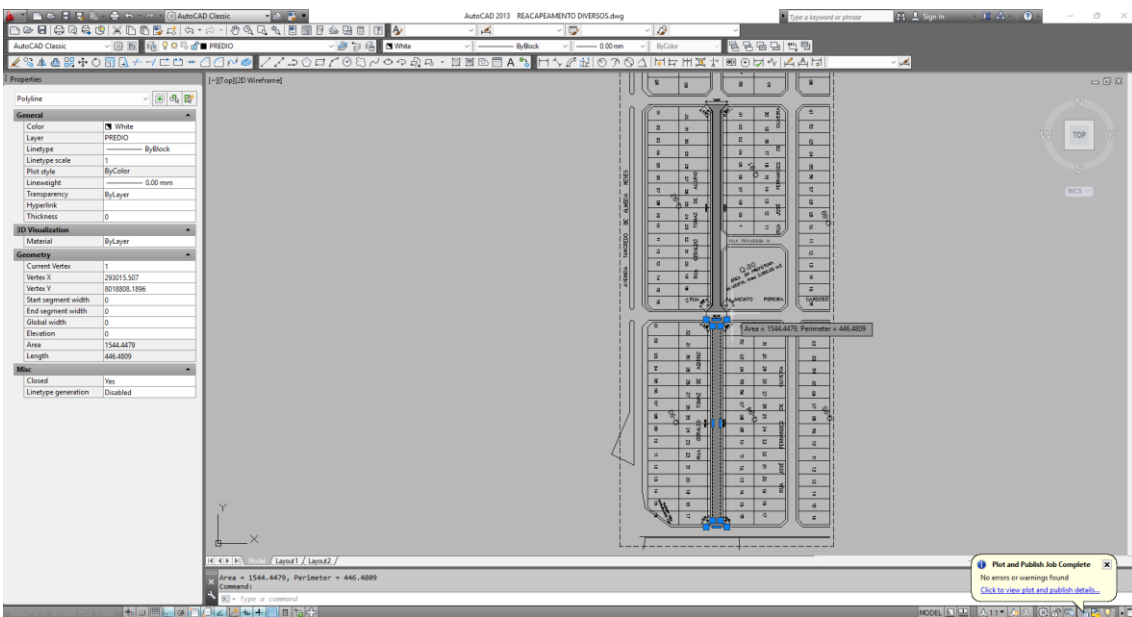

AREA 2 – 1.544,44 m2.

TOTAL RUA GERALDO TOMAS DE AQUINO = ( 1.544,44 + 1.544,44 ) = **3.088,88 m².**

## RUA JOSE FERNANDES DE OLIVEIRA:

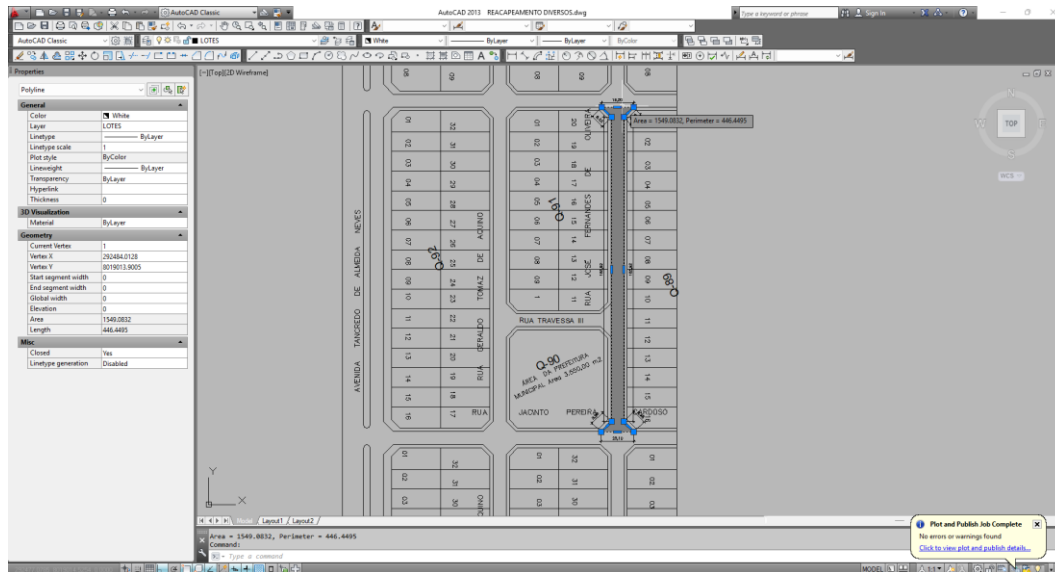

AREA = 1.549,08 M2.

## RUA JACINTO PEREIRA CARDOSO:

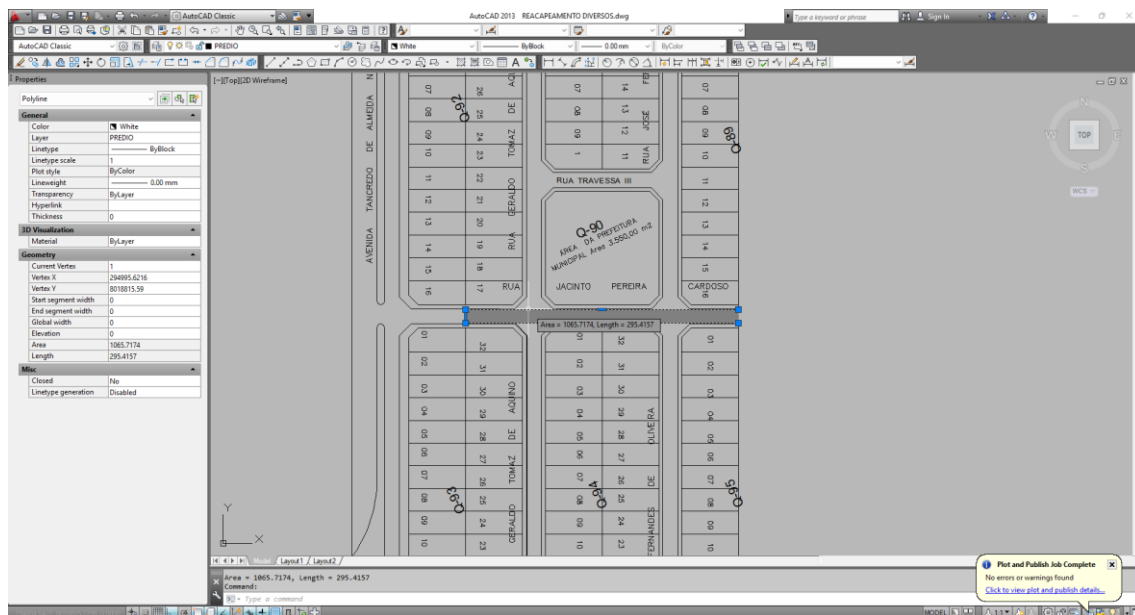

AREA= 1.065,71 m2.

## RUA RIO DE JANEIRO:

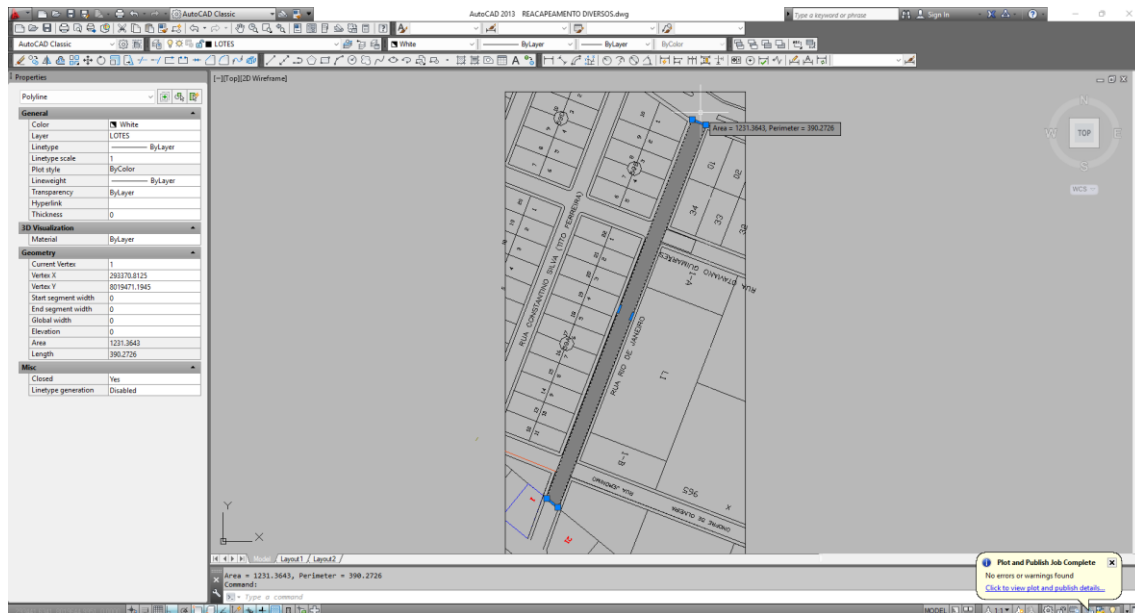

AREA 1 = 1.231,36 m2.

## RUA OTAVIANO GUIMARÃES:

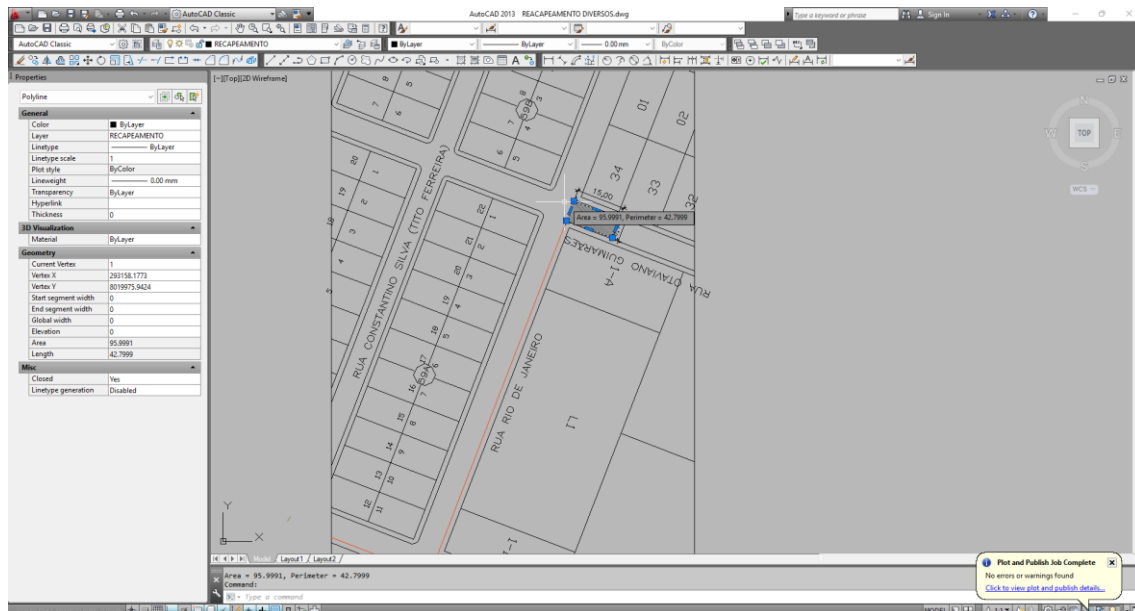

AREA = 95,99 m2.

## RUA PEREIRA GUIMARÃES:

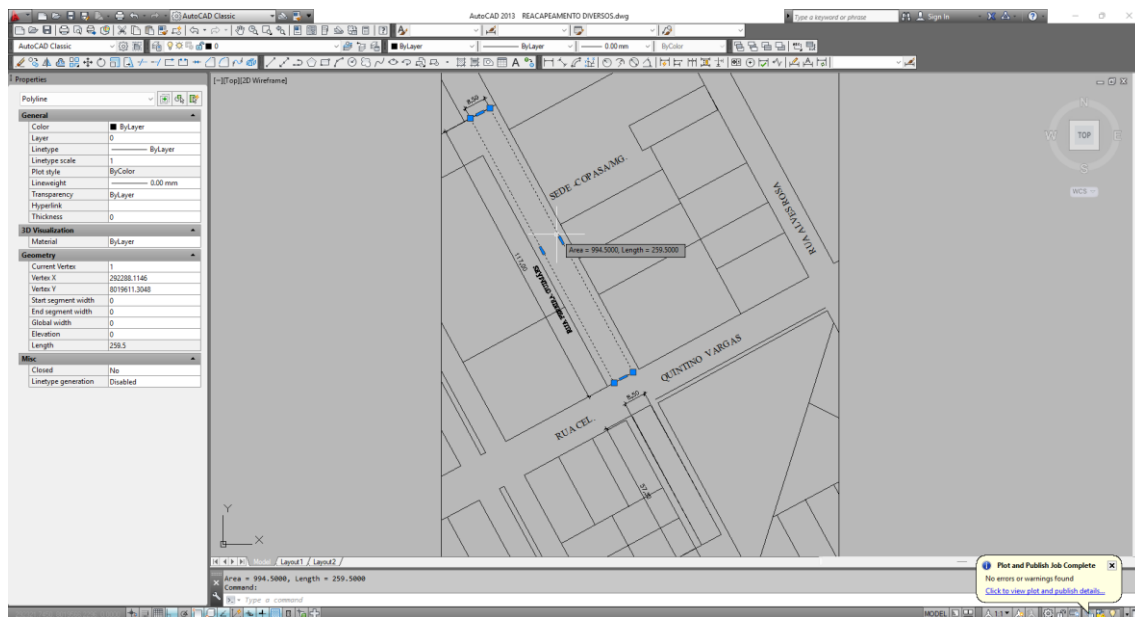

AREA 1 – 994,50 m2.

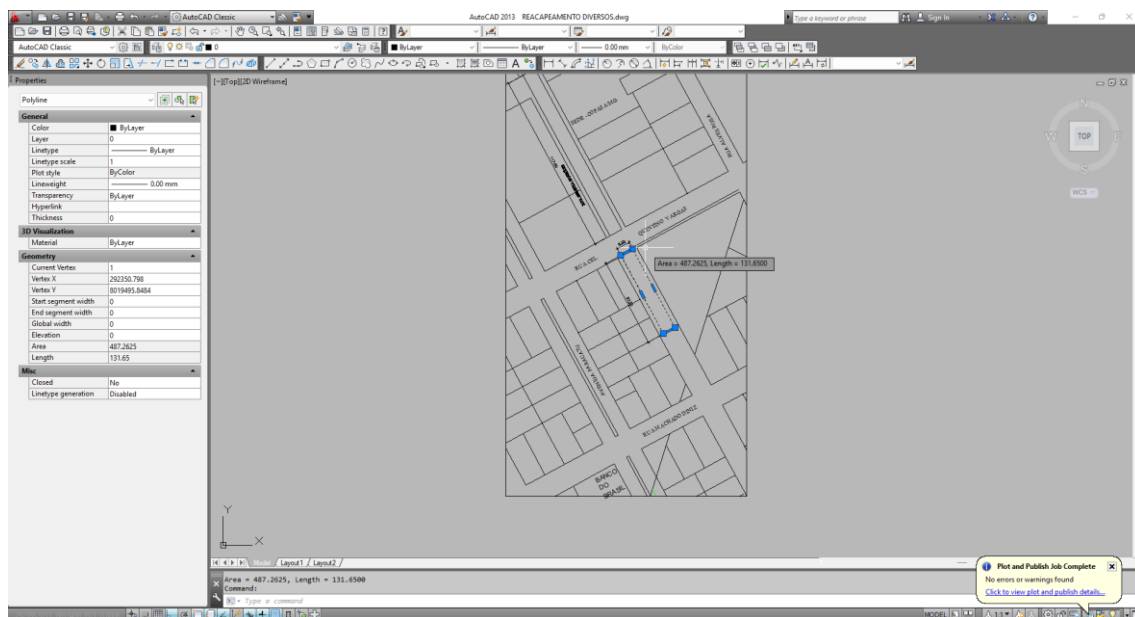

AREA 1 – 487,26 m2.

TOTAL RUA PEREIRA GUIMARÃES : ( 994,50 + 487,26) = 1.481,76 m2.



ITEM 3.4 - EXECUÇÃO DE PASSEIO (CALÇADA) OU PISO DE CONCRETO COM CONCRETO MOLDADO IN LOCO, USINADO C25, ACABAMENTO CONVENCIONAL.

MARCO VISUAL “CARRO DE BOIS”:

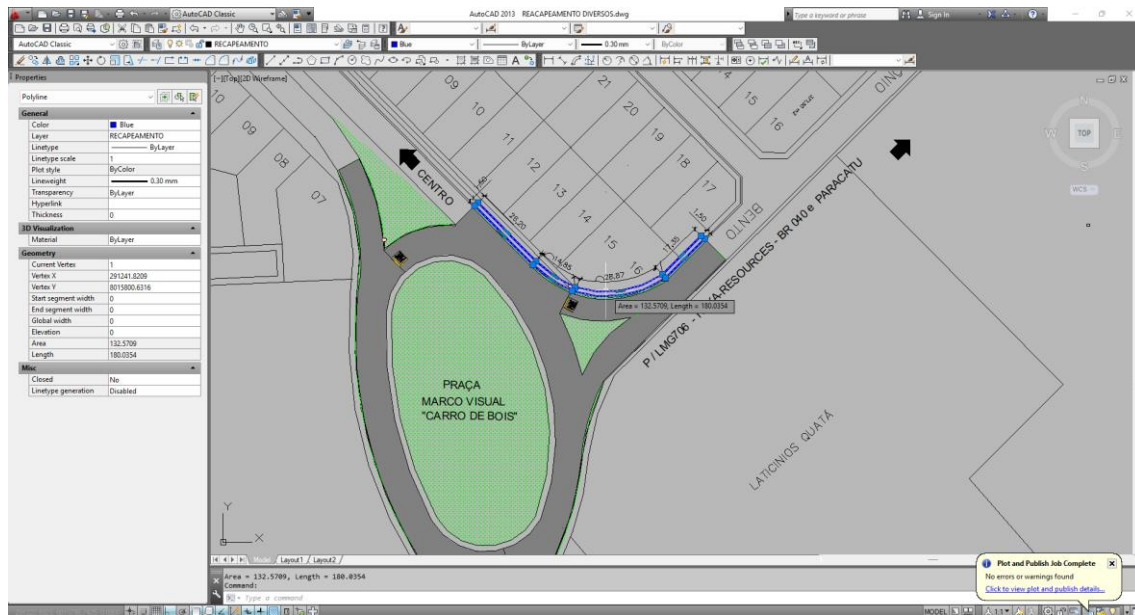

AREA DO PASSEIO 132,57 m2.